

# Anyone Can Answer Radios

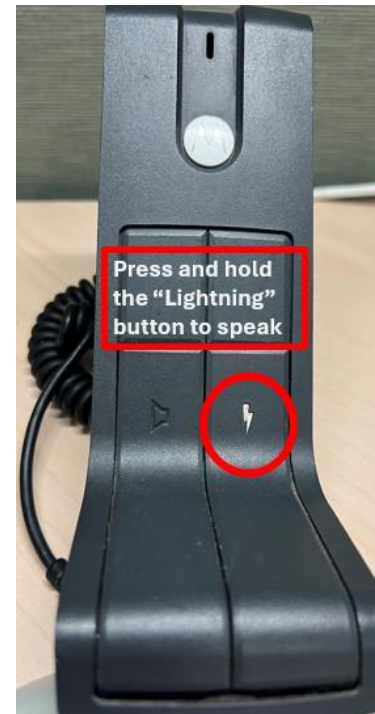

## How to respond when your hospital is called out

- Press and hold mic button
- Wait a second or two before speaking
- State "[Name of hospital] copies, over"
- Use plain language when responding, no number or color codes

Any concerns with radios, contact IHA at [chscpr@team-iha.org](mailto:chscpr@team-iha.org)

For missed notices, email the CDPH Public Health Emergency Operations Center (PHEOC) at [CDPHPHEOC@CityofChicago.Org](mailto:CDPHPHEOC@CityofChicago.Org)

## Hospital Radio Setup

- STARCOM21
  - New radios – Zone IDPH B, Channel13 (screen will read “EMS R11”)
  - Older radios – Zone B, Channel 15 (screen will read “B EMS R11”)

**Note:** If you see anything other than that, you may have to switch it back

- New radios



- Older radios



1. Press the “Zone” Button to change zones and choose Zone B
2. Press the “Home” Button when on the right Zone
3. Use the dial to navigate to “B EMS R11”, on channel 15.