

# Anyone Can Answer Radios

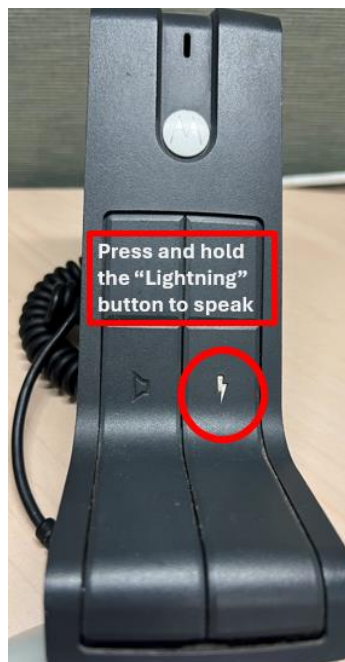

For clarification on messages, email  
CDPH Public Health Emergency  
Operations Center (PHEOC) at  
[CDPHPHEOC@CityofChicago.Org](mailto:CDPHPHEOC@CityofChicago.Org)

## How to respond when your hospital is called out

- Press and hold mic button
- Wait a second or two before speaking
- State "[Name of hospital] copies, over"
- Use plain language when responding, no number or color codes

Deliver vital radio communication  
information to:

Hospital's Emergency Contact

Contact number

## Hospital Radio Setup

- STARCOM21
  - New radios – Zone IDPH B, Channel13 (screen will read “IDPH B EMS R11”)
  - Older radios – Zone B, Channel 15 (screen will read “B EMS R11”)

**Note:** If you see anything other than that, you may have to switch it back

- New radios

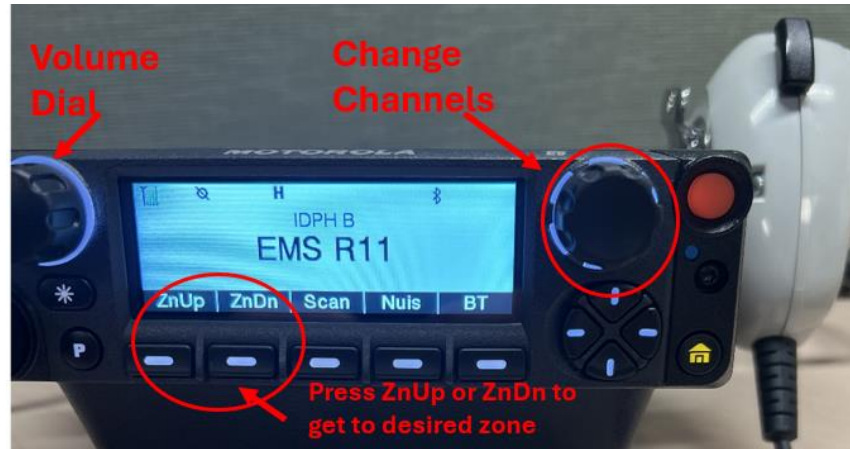

- Older radios



1. Press the “Zone” Button to change zones and choose Zone B
2. Press the “Home” Button when on the right Zone
3. Use the dial to navigate to “B EMS R11”, on channel 15.

Any concerns with radios, contact IHA at [chscpr@team-ih.org](mailto:chscpr@team-ih.org)